

THIS DRAWING IS UNPUBLISHED.

RELEASED FOR PUBLICATION

2011

© COPYRIGHT 2011

ALL RIGHTS RESERVED.

LOC
IR

DIST
-

REVISIONS

P	LTR	DESCRIPTION	DATE	DWN	APVD
	A	INITIAL RELEASE	18JUL2011	PKS	RRP
	A1	CAVITY DWG INFO CORRECTED	29SEP2011	PKS	RRP

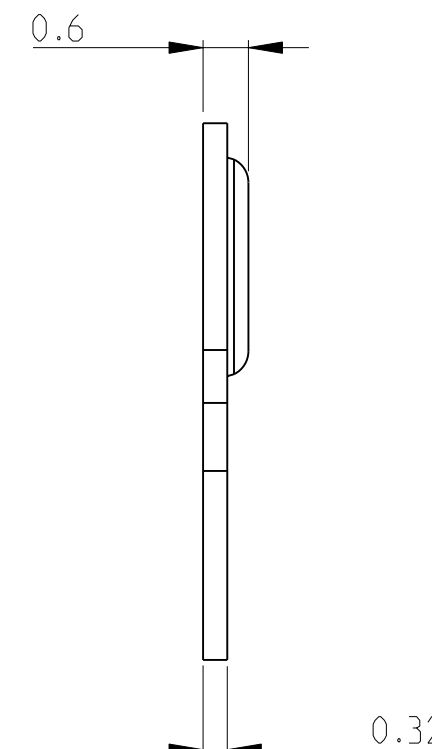
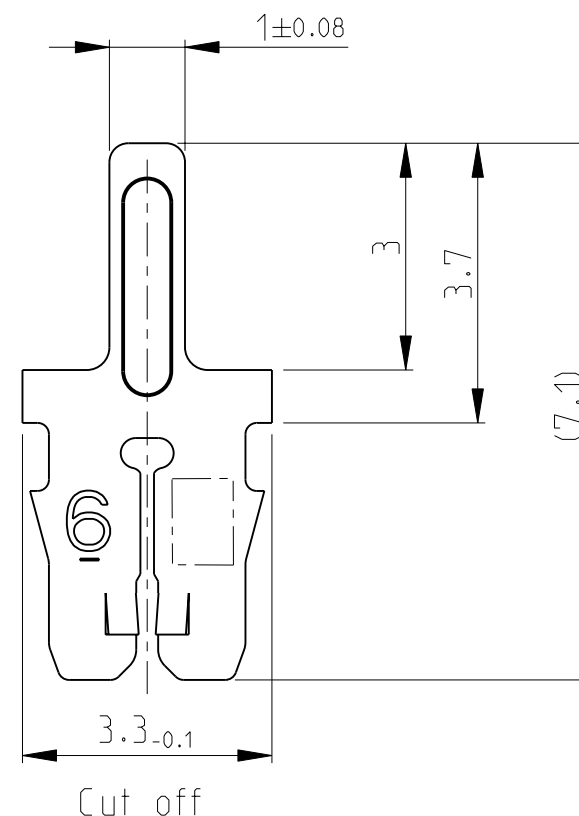
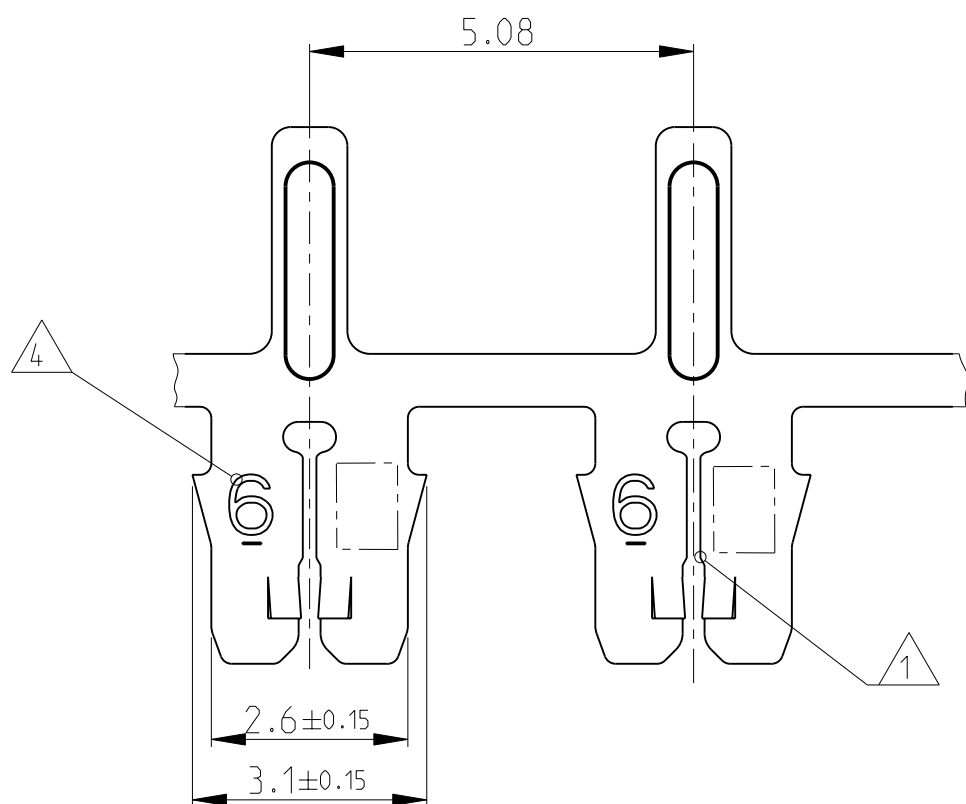

Bemerkungen:
NOTES

- 1 Geeignet fuer Kupferlackdraht $\varnothing 0.265...0.335$ mm
Einzeldraht oder zwei Draehte gleichen Durchmessers
SLOT ACCEPTS:
SINGLE OR DOUBLE MAGNET WIRE
SAME DIAMETERS 0.265...0.335mm DIA
- 2 Anlieferungszustand: Kontakte fortlaufend mit
Papierzzwischenlage auf Kunststoffspule aufgewickelt
Max. 5 Splice Stellen pro Spule
Splice Stellen nicht miteinander verbunden
DELIVERYSTATE: CONTACTS CONTINUOUS REELED WITH PAPER
INTERLAYER ON PLASTIC-REEL.
MAX. 5 SPLICES PER REEL
SPLICES BE NOT BONDED TOGETHER.
- 3 Kontaktkammer nach Zeichnung } Spec. 411-18513
CAVITY ACCORDING DWG.
- 4 Kennziffer fuer Drahtgroessenbereich (6)
IDENTIFICATION NO. FOR MAGNET WIRE RANGE (6)
- 5 Materialdicke } 0.32 ± 0.02
STOCK THICKNESS

1987500-1	A	CuSn	PRETINNED	MAG-MATE .187 mod.
PART NO	REV.	MATERIAL	SURFACE COLOR	DESCRIPTION

THIS DRAWING IS A CONTROLLED DOCUMENT.		DWN J.Kohle 28Jul08	TE Connectivity				
DIMENSIONS: mm		CHK S.Zabeck 30Jul08				NAME MAG-MATE Kontakt mit Loetpin	
TOLERANCES UNLESS OTHERWISE SPECIFIED:		APVD T.Klenner 04Aug2008				PRODUCT SPEC -	
		APPLICATION SPEC -					
MATERIAL SEE TABLE		FINISH SEE TABLE	WEIGHT -	SIZE A3	CAGE CODE 00779		
CUSTOMER DRAWING			DRAWING NO. C-1987500	RESTRICTED TO -			
			SCALE 10:1	SHEET 1 OF 1	REV A1		